



The 1006 Series is also available in a **Complete One Box Solution**

# 1006 Series

## The strongest, most versatile electric strike available

Shown with KM Option

The 1006 series is the strongest and most versatile electric strike available. The dual interlocking plunger design and heavy duty stainless steel construction, enables it to exceed every standard developed for electric strikes. With multiple faceplate options, the 1006 will fully accommodate every lock designed to work within an ANSI 4-7/8" strike plate. Tested to exceed 3,000 lbs of static strength, 350 ft-lbs of dynamic strength and factory tested to exceed 1,000,000 cycles of operation, the 1006 is in a class of its own.

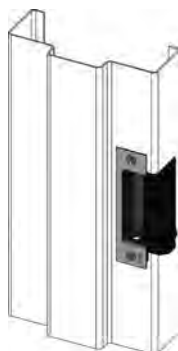

### Specifications

- UL 10C fire-rated, 3 hour single door (fail secure only)
- UL 10C fire-rated, 1-1/2 hour double door (fail secure only)
- CAN4-S104(ULC-S104) fire door conformant
- ANSI/SDI A250.13 windstorm resistant
- ANSI-ASTM E330
- Florida Building Code approved TAS 201, 202, 203
- UL 1034 burglary-resistant listed and suitable for outdoor use
- UL 294 (6th Edition) listed
- ANSI/BHMA A156.31, Grade 1
- NFPA-252 fire door conformant
- ASTM-E152 fire door conformant
- RoHS compliant
- Environmental Product Declaration
- Patents: 6,021,038; 6,595,564, & 9,183,976

### Frame Application

- Metal
- Wood

### Electrical (continuous duty)

- .45 Amps at 12 VDC
- .25 Amps at 24 VDC

## 1006 Models

<b>1006</b>	Universal electric strike	Faceplate options ordered separately, see pages 12-16
<b>1006CAS</b>	Complete electric strike	Includes the N, ND, and NM faceplates
<b>1006CS</b>	Complete electric strike	Includes the SMART Pac II and J, KD, KM, HM, and AD faceplates
<b>1006CLB</b>	Complete electric strike	Includes the J, KD, and KM faceplates
<b>1006CDB</b>	Complete electric strike	Includes the ND and NM faceplates
<b>RF1016</b>	Integrated Prox	Includes the strike body, Prox reader and door position switch
<b>IC1026</b>	Integrated iCLASS®	Includes the strike body, iCLASS reader and door position switch

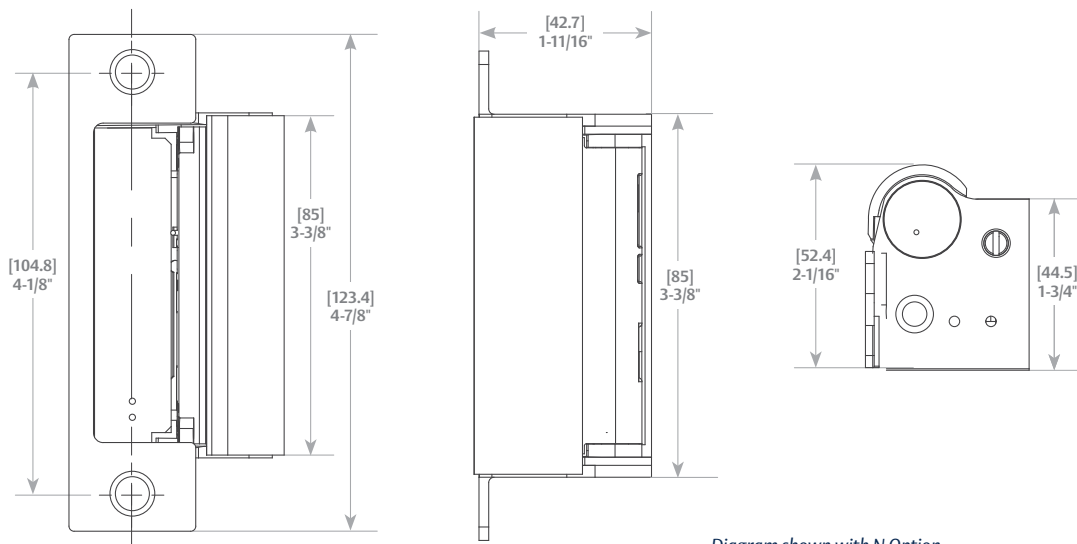

Diagram shown with N Option

### Standard Features

- Stainless steel construction
- Tamper-resistant
- Static strength 3,070 lbs (fail secure)
- Dynamic strength 350 ft-lbs (fail secure)
- Endurance 1,000,000 cycles
- Fail secure
- Dual-voltage 12 VDC or 24 VDC continuous duty
- Non-handed
- Internally mounted solenoid
- Accommodates up to 1" deadbolt
- Plug-in connector
- Full keeper shims for horizontal adjustment
- Trim enhancer
- 5 Year limited warranty

### Optional Features

- LBM** » Latchbolt monitor
- LBSM** » Latchbolt strike monitor
- Fail safe
- Interchangeable faceplates

*Monitor Switches may not work with all faceplate options (see pages 12-16)*

### Accessories

- 1000-102** » Rain guard
- 1006-103** » Full keeper shims
- 1000-104** » Lip extension trim adapter
- 1006-105** » Trim enhancer BLK (goof plate)
- 1006-109** » Trim adapter
- 1000-110** » Replacement strike plate
- 1000-130** » KD filler plate

- 150** » Strike latch guard
- HES-CUT-MTK** » Metal template kit
- 2004M** » ElectroLynx® adapter
- 2005M3** » SMART Pac® III
- 2006M** » Plug-in buzzer

### Finishes

- 630** » Satin stainless steel
- 605** » Bright brass
- 606** » Satin brass
- 612** » Satin bronze
- 613** » Bronze toned
- 629** » Bright stainless steel
- BLK** » Black

*\*Complete Pacs are only available in the 630 finish*



CYLINDRICAL  
LOCKSETS



MORTISE LOCKS WITH  
DEADBOLTS



MORTISE LOCKS  
WITHOUT  
DEADBOLTS



SPECIALTY  
LOCKSETS



WINDSTORM



FIELD SELECTABLE  
(12 OR 24VDC)



FIRE RATED



GRADE 1



OUTDOOR  
RATED



UL 1034  
BURGLARY  
LISTED

hes  
ASSA ABLOY

# 1006 Series Faceplate Options



**Operation:** The hookbolt is released by a single keeper. The keeper is held open to recapture the latchbolt and hookbolt when the door is closed.

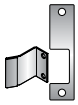

4-7/8" x 1-1/4"

## R Option

**For use with:** Adams Rite style hookbolt up to 1" throw

» ANSI/BHMA Numbers: E09391, E09392, E09393, E09332, E09333

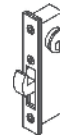

**Operation:** After releasing the latchbolt, the keeper returns to the locked position



4-7/8" x 1-1/4"

## Z Option

**For use with:** Unit and Mono locks

» ANSI/BHMA Numbers: E09321, E09322, E09323

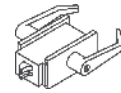

**Operation:** After releasing the latchbolt, the keeper returns to the locked position



9" x 1-3/8"

## J-2 Option

**For use with:** All cylindrical locks up to a 3/4" latchbolt

» ANSI/BHMA Numbers: E09321, E09322, E09323



**Operation:** After releasing the latchbolt, the keeper returns to the locked position



9" x 1-3/8"

## KM-2 Option

**For use with:** Mortise locksets up to a 3/4" latchbolt

» ANSI/BHMA Numbers: E09321, E09322, E09323

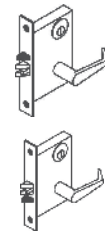

"For use with" information is offered as a recommendation only. Reference should be made to the lockset manufacturer for proper installation instructions necessary to meet compatibility requirements.

Continued on next page »

# 1006 Series Faceplate Dimensions

**J, E**  
Faceplate Option

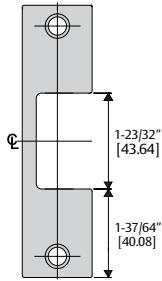

**K**  
Faceplate Option

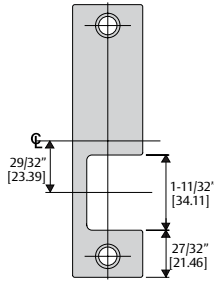

**KD**  
Faceplate Option

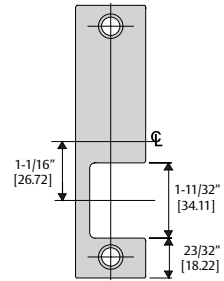

**KM**  
Faceplate Option

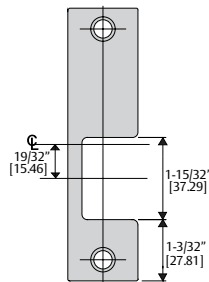

**H, HT, N**  
Faceplate Option

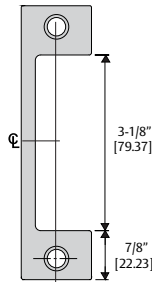

**HD, ND**  
Faceplate Option

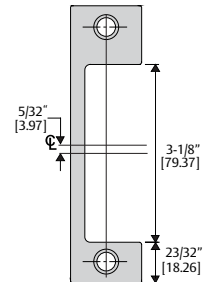

**HM, NM**  
Faceplate Option

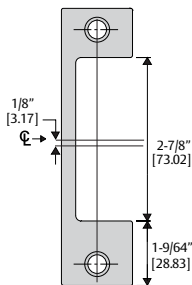

**R**  
Faceplate Option

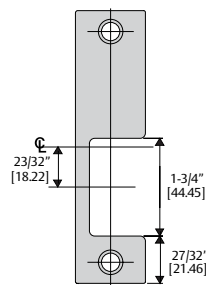

**Z**  
Faceplate Option

