



The 1006 Series is also available in a **Complete One Box Solution**

1006 Series

The strongest, most versatile electric strike available

Shown with KM Option

The 1006 series is the strongest and most versatile electric strike available. The dual interlocking plunger design and heavy duty stainless steel construction, enables it to exceed every standard developed for electric strikes. With multiple faceplate options, the 1006 will fully accommodate every lock designed to work within an ANSI 4-7/8" strike plate. Tested to exceed 3,000 lbs of static strength, 350 ft-lbs of dynamic strength and factory tested to exceed 1,000,000 cycles of operation, the 1006 is in a class of its own.

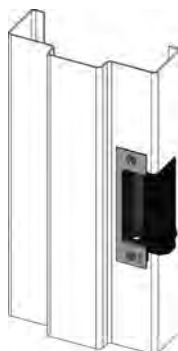

Specifications

- UL 10C fire-rated, 3 hour single door (fail secure only)
- UL 10C fire-rated, 1-1/2 hour double door (fail secure only)
- CAN4-S104(ULC-S104) fire door conformant
- ANSI/SDI A250.13 windstorm resistant
- ANSI-ASTM E330
- Florida Building Code approved TAS 201, 202, 203
- UL 1034 burglary-resistant listed and suitable for outdoor use
- UL 294 (6th Edition) listed
- ANSI/BHMA A156.31, Grade 1
- NFPA-252 fire door conformant
- ASTM-E152 fire door conformant
- RoHS compliant
- Environmental Product Declaration
- Patents: 6,021,038; 6,595,564, & 9,183,976

Frame Application

- Metal
- Wood

Electrical (continuous duty)

- .45 Amps at 12 VDC
- .25 Amps at 24 VDC

1006 Models

1006	Universal electric strike	Faceplate options ordered separately, see pages 12-16
1006CAS	Complete electric strike	Includes the N, ND, and NM faceplates
1006CS	Complete electric strike	Includes the SMART Pac II and J, KD, KM, HM, and AD faceplates
1006CLB	Complete electric strike	Includes the J, KD, and KM faceplates
1006CDB	Complete electric strike	Includes the ND and NM faceplates
RF1016	Integrated Prox	Includes the strike body, Prox reader and door position switch
IC1026	Integrated iCLASS®	Includes the strike body, iCLASS reader and door position switch

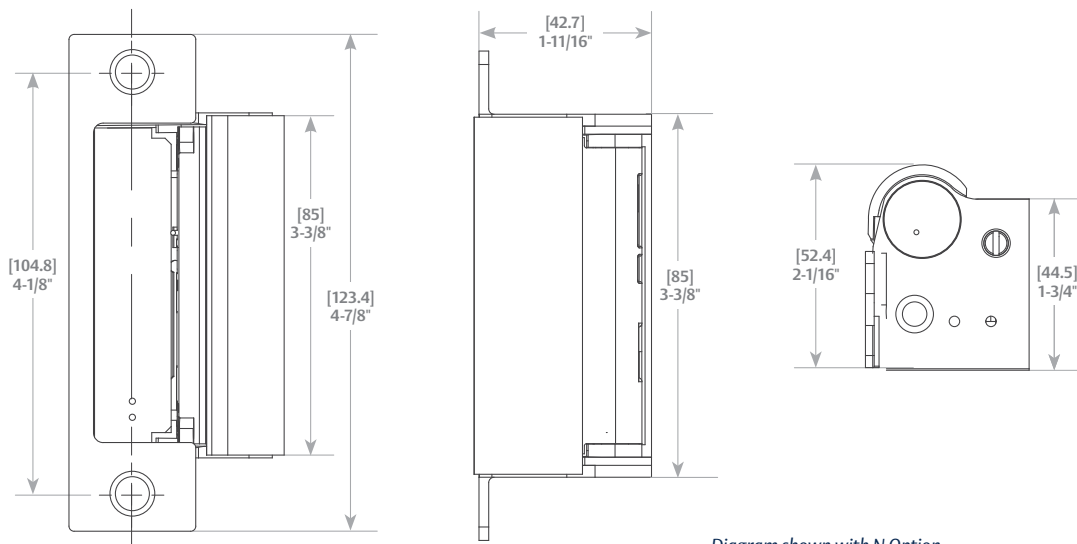

Diagram shown with N Option

Standard Features

- Stainless steel construction
- Tamper-resistant
- Static strength 3,070 lbs (fail secure)
- Dynamic strength 350 ft-lbs (fail secure)
- Endurance 1,000,000 cycles
- Fail secure
- Dual-voltage 12 VDC or 24 VDC continuous duty
- Non-handed
- Internally mounted solenoid
- Accommodates up to 1" deadbolt
- Plug-in connector
- Full keeper shims for horizontal adjustment
- Trim enhancer
- 5 Year limited warranty

Optional Features

- LBM** » Latchbolt monitor
- LBSM** » Latchbolt strike monitor
- Fail safe
- Interchangeable faceplates

Monitor Switches may not work with all faceplate options (see pages 12-16)

Accessories

- 1000-102** » Rain guard
- 1006-103** » Full keeper shims
- 1000-104** » Lip extension trim adapter
- 1006-105** » Trim enhancer BLK (goof plate)
- 1006-109** » Trim adapter
- 1000-110** » Replacement strike plate
- 1000-130** » KD filler plate

- 150** » Strike latch guard
- HES-CUT-MTK** » Metal template kit
- 2004M** » ElectroLynx® adapter
- 2005M3** » SMART Pac® III
- 2006M** » Plug-in buzzer

Finishes

- 630** » Satin stainless steel
- 605** » Bright brass
- 606** » Satin brass
- 612** » Satin bronze
- 613** » Bronze toned
- 629** » Bright stainless steel
- BLK** » Black

**Complete Pacs are only available in the 630 finish*



CYLINDRICAL
LOCKSETS



MORTISE LOCKS WITH
DEADBOLTS



MORTISE LOCKS
WITHOUT
DEADBOLTS



SPECIALTY
LOCKSETS



WINDSTORM



FIELD SELECTABLE
(12 OR 24VDC)



FIRE RATED



GRADE 1



OUTDOOR
RATED



UL 1034
BURGLARY
LISTED

hes
ASSA ABLOY

1006CS Smart Strike™

The **Complete One Box Solution** for all cylindrical and mortise locksets, with or without a 1" deadbolt

The **1006CS Smart Strike** includes a 1006 electric strike body and SMART Pac® III plus faceplates and brackets that can provide the same function as any of the following options:

J Option	H Option	HTD Option
K Option	HD Option	N Option
KD Option	HM Option	ND Option
KM Option	HT Option	NM Option

Compatible Locksets:

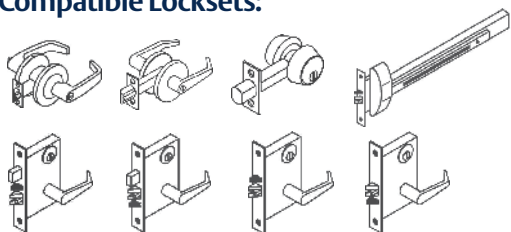

1006CAS Complete for Recapture

The **Complete One Box Solution** for deadbolt recapture

The **1006CAS** includes the 1006 electric strike body plus faceplates and brackets that provide the same function as any of the following options:

N Option	ND Option	NM Option
----------	-----------	-----------

Compatible Locksets:

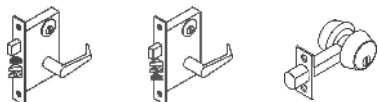

*Complete Pacs are only available in the 630 finish

1006CLB Complete for Latchbolt Locks

The **Complete One Box Solution** for all cylindrical and mortise locksets

The **1006CLB** includes the 1006 electric strike body plus faceplates and brackets that provide the same function as any of the following options:

J Option	KD Option
K Option	KM Option

Compatible Locksets:



1006CDB Complete for Deadbolt Locks

The **Complete One Box Solution** for all locksets with a 1" deadbolt

The **1006CDB** includes the 1006 electric strike body plus faceplates and brackets that provide the same function as any of the following options:

H Option	HT Option	ND Option
HD Option	HTD Option	NM Option
HM Option	N Option	

Compatible Locksets:

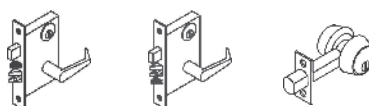

1006 Series Faceplate Options



Operation: This deadbolt solution offers three modes of functionality; night latch, lockout, and normally extended deadbolt. (Functional operation modes described below.)



9" × 1-3/8"

DB-2 Option

The Deadbolt Solution: Includes all hardware to retain, release and recapture all mortise locks, and tubular deadbolts up to a 1" latchbolt

Mode 1: Night latch function. The deadbolt is retracted during traffic hours. The latchbolt is released by the keeper and keeper returns to the locked position.

Mode 2: Lockout function. The electric strike will not release if the deadbolt is extended.

Replaces the N-2, A-2, T-2, and H-2 options

» ANSI/BHMA Numbers: E09391, E09392, E09393, E09331, E09332, E09333



Operation: After releasing the latchbolt, the keeper returns to the locked position



4-7/8" × 1-1/4"

J Option

For use with: Cylindrical locksets up to 3/4" throw and all locksets with center-lined bolts

Compatible locksets: All brands of cylindrical latchbolts

» ANSI/BHMA Numbers: E09321, E09322, E09323



Operation: After releasing the latchbolt, the keeper returns to the locked position



4-7/8" × 1-1/4"

KD Option

For use with: Mortise locksets up to 3/4" throw latchbolt

Compatible locksets: Dorma 9500, Jackson, Sargent (7700 & 8100), Schlage, Yale (8700)

» ANSI/BHMA Numbers: E09321, E09322, E09323



4-7/8" × 1-1/4"

KM Option

For use with: Mortise locksets up to 3/4" throw latchbolt

Compatible locksets: Accurate, Arrow, Baldwin, Best, Corbin Russwin, Falcon, Marks, PDQ, Sargent (7800, 8200 & 9200), Yale (8800)

» ANSI/BHMA Numbers: E09321, E09322, E09323

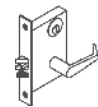

"For use with" information is offered as a recommendation only. Reference should be made to the lockset manufacturer for proper installation instructions necessary to meet compatibility requirements.

1006 Series Faceplate Dimensions

J, E
Faceplate Option

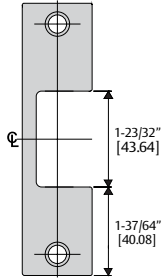

K
Faceplate Option

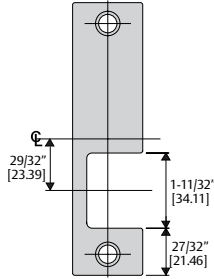

KD
Faceplate Option

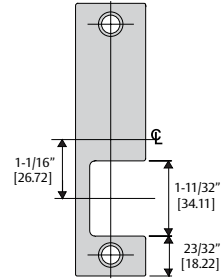

KM
Faceplate Option

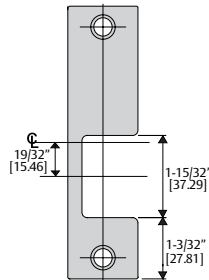

H, HT, N
Faceplate Option

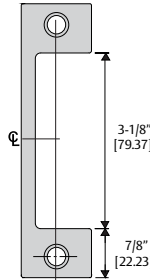

HD, ND
Faceplate Option

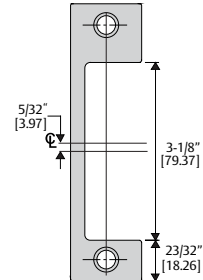

HM, NM
Faceplate Option

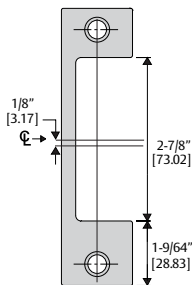

R
Faceplate Option

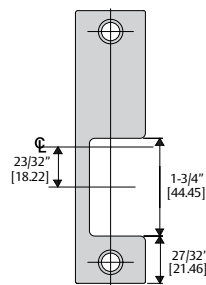

Z
Faceplate Option

