

DS-2CE56D5T-AVFIR

HD1080p Indoor Varifocal IR Dome Camera

TurboHD™



Key Features

- 2 MP High-Performance CMOS
- Analog HD Output, Up to 1080p Resolution
- 2.8 mm to 12 mm Varifocal Lens
- True Day/Night
- OSD Menu, 3D DNR, Smart IR
- Up to 30 Meters IR Range
- UTC Function
- 24 VAC/12 VDC

Dimensions

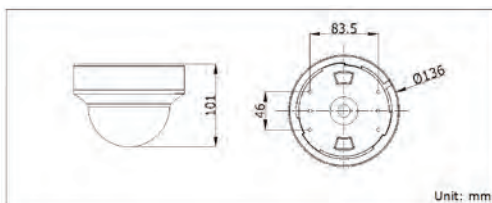

Accessories



Video Balun
DS-1H18

Order Models

DS-2CE56D5T-AVFIR

DS-2CE56D5T-AVFIR	
Camera	
Image Sensor	2 MP CMOS image sensor
Signal System	NTSC
Effective Pixels	1920 x 1080
Minimum Illumination	0.014 lux @ (f/1.4, AGC on), 0 lux with IR
Shutter Speed	1/25 s to 1/50,000 s
Lens	2.8 mm to 12 mm @ f/1.4
	Angle of view: 92° to 32°
Lens Mount	φ14
Angle Adjustment	Pan: 0° to 355°, tilt: 0° to 180°, rotation: 0° to 355°
Day/Night	ICR
Synchronization	Internal synchronization
Video Frame Rate	1080p @ 25 fps/1080p @ 30 fps
HD Video Output	1 analog HD output
CVBS Output	1 Vp-p composite output (75 Ω/BNC)
S/N Ratio	More than 52 dB
Menu	
Scene	Indoor, Outdoor, Indoor1, LOW-LIGHT
Camera ID	On/off (15 characters, position programmable)
AGC	Supported
D/N Mode	Color/BW/EXT
White Balance	ATW, AWC-SET, Indoor, Outdoor, Manual
Privacy Mask	On/Off, maximum 8 zones
Motion Detection	On/Off, maximum 4 zones
BLC/WDR	Yes/120 dB
Anti-Flicker	On/off
Functions	HSBLC (Eclipse), digital noise reduction, digital zoom(62x), slow shutter, mirror, defog, defect pixel correction, SMART D-ZOOM
General	
Working Temperature/ Humidity	-30° C to 60° C (-22° F to 140° F) Humidity 90% or less (non-condensing)
Power Supply	12 VDC, 24 VAC
Power Consumption	12 VDC: maximum 4.5 W 24 VAC: maximum 6.5 W
Weatherproof Ratings	IP66
IR Range	Up to 30 m
Communication	Up-the-Coax (need UTC controller)
Dimensions	Φ136 mm × 101 mm (Φ5.35" × 3.98")
Weight	380 g (0.84 lb)