

NET5308T Video Encoder

8 INPUTS, EXPANDABLE TO 16 INPUTS, DUAL-STREAM, NTSC/PAL



Product Features

- 8 Video Inputs, Expandable to 16 Video Inputs
- Dual MPEG-4 Video Streams per Input
- Up to 30 High Quality (4CIF) Images per Second per Stream
- Unicast and multicast transmission supports simultaneous viewing on multiple workstations and uninterrupted recording
- Adaptive Deinterlacing Technology
- 8 Programmable Alarm Inputs (Supervised or Unsupervised), 4 Relay Outputs, Expandable to 16 Alarm Inputs and 8 Relay Outputs
- 2 Security Modes
- Built-in PTZ Support using Pelco P or Pelco D (RS-422) and Coaxitron® (Up-the-Coax) Protocols



NET5308T
(INCLUDES 8 INPUTS AND BASE MODULE)



NET5308T-EXP
(OPTIONAL 8 INPUT EXPANSION UNIT)

The **NET5308T** is a high performance, dual-stream, 8-input video encoding unit. Its main function is to convert live analog video signals into dual MPEG-4 streams. It can process up to 30 high quality images per second (ips) per stream. In addition, the **NET5308T** uses motion adaptive deinterlacing technology to reduce jitter in 4CIF images.

The **NET5308T** incorporates EnduraView™ video optimization technology to select the best image quality and frame rate for the target Endura® product (decoder, workstation, console), all without affecting the system recording rate.

The **NET5308T** offers both unsecured and secured modes. The secure mode uses a key system to prevent unauthorized devices from communicating with a **NET5308T** over the Endura network. The system also supports both multicast and unicast transmission to optimize network usage for the given application.

The **NET5308T** is also designed for maximum system integration and flexibility. The **NET5308T-EXP** adds 8 video inputs to the **NET5308T** for easy expansion to 16 video inputs on the same network port. With its USB 2.0 technology, you can expand the **NET5308T** without redesigning your network.

With integrated audio and PTZ control, the NET5300 Series of encoders provides the ideal solution for moving large groups of analog cameras onto the Endura IP video surveillance system.

Endura distributed, network-based products are available only to certified dealers/integrators. Please contact your local sales representative for details on certification applications and requirements. Additional information on Endura products and certifications may be found at <http://www.pelco.com/endura>

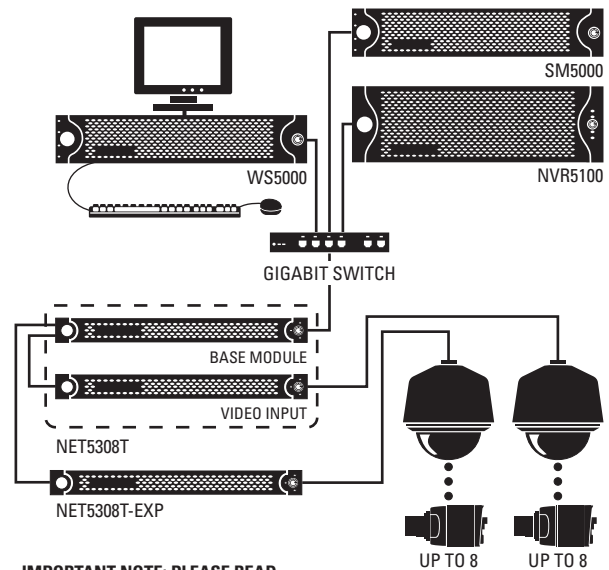

IMPORTANT NOTE: PLEASE READ.

The network implementation is shown as a general representation only and is not intended to show a detailed network topology. Your actual network will differ, requiring changes or perhaps additional network equipment to accommodate the system as illustrated. Please contact your local Pelco Representative to discuss your specific requirements.

NOTICE: Judgment as to the suitability of the products for users' purposes is solely the users' responsibility. Users should refer to the Operation manuals for cautionary statements regarding user selected options and how they might affect video quality. Users shall determine the suitability of the products for their own intended application, picture rate and picture quality. In the event users intend to use the video for evidentiary purposes in a judicial proceeding or otherwise, users should consult with their attorney regarding any particular requirements for such use.



TECHNICAL SPECIFICATIONS

MODELS

NET5308T	1 base module and 1 video input module; encodes 8 video inputs, 8 audio inputs, and control data for transmission over an IP network; includes 8 alarm inputs and 4 relay outputs
NET5308T-EXP	Encodes an additional 8 video inputs, 8 audio inputs, and control data for transmission and integration with the NET5308T; adds 8 alarm inputs and 4 relay outputs

SUPPLIED ACCESSORIES

NET5308T	6 power cables (2 USA standard, 2 European standard, 2 UK standard) 1 USB 2.0 cable 2 alarm and 2 relay terminal blocks Serial PTZ kit (1 straight cable, 1 reverse cable, 1 breakout box)
NET5308T-EXP	3 power cables (1 USA standard, 1 European standard, 1 UK standard) 1 USB 2.0 cable 2 alarm and 2 relay terminal blocks

VIDEO/AUDIO

Video Standards	NTSC/PAL/EIA/CCIR composite	
Video Coding	MPEG-4	
Video Streams	2, simultaneous per input	
Video Resolutions	NTSC	PAL
4CIF	704 x 480	704 x 576
2CIF	704 x 240	704 x 288
CIF	352 x 240	352 x 288
QCIF	176 x 120	176 x 144
Video Inputs (Video/Expansion)	8, BNC, looping, 0.5-1 Vp-p	
Video Termination	Software controlled	
Video Sequence Output (Video/Expansion)	1, BNC, 1 Vp-p	
Audio Encoding	G.711 speech codec	
Audio Bit Rate	64 kbps	
Audio Levels	1 Vp-p, 10 kohms	
Audio Connectors	8, 3.5 mm monaural	
Connector Tip	Signal high	
Connector Sleeve	Common	
Audio Inputs	Line in	

PTZ CONTROL

PTZ Interface	RS-422, Video in
PTZ Protocols	Coaxitron (video/expansion) Pelco D/Pelco P (base)

ALARMS/RELAYS

Alarm Inputs	8, programmable, 5.0 VDC 10 kohms, triggered; expandable to 16
Relay Output	4, form-C relay, 30 VDC, 1 A; expandable to 8

VIDEO ACTIVITY DETECTION

Zones	3 plus background zone
Zone Types	Any shape, user-definable in 16 x 16 pixel blocks
Sensitivity	Adjustable

POWER

Power Input	100 to 240 VAC 50/60 Hz, autoranging
Power Consumption (maximum)	40 W, 137 BTU/H (each module)

AUXILIARY INTERFACES

Base Module

Network Connector	1 Gigabit Ethernet RJ-45 port (1000Base-T)
USB 2.0	3 high-speed USB 2.0 ports on rear panel
Camera Control	1 RJ-45 connector; RS-422 to CM9760-CDU-T; Pelco D/Pelco P protocol

Video/Expansion

Alarms	2, 8-pin terminal block
Relays	2, 6-pin terminal block

FRONT PANEL INDICATORS/FUNCTIONS

Base Module

Power	Blue
Status	Green, amber, red
Network Link/Speed	Green, amber
Network Activity	Green
Video	Green, red

Video/Expansion

Power	Blue
Video status	Red
Video operation	Green
Unit Status	Green, amber, red

ENVIRONMENTAL

Operating Temperature	50°F to 95°F (10° to 35°C) at unit air intake (front of unit)
Storage Temperature	-40° to 149°F (-40° to 65°C)
Operating Humidity	20% to 80%, noncondensing
Maximum Humidity	Gradient 10% per hour
Operating Altitude	-50 ft to 10,000 ft (-15.2 m to 3,048 m)
Operating Vibration	0.25 G at 3 Hz to 200 Hz at a sweep rate of 0.5 octave/minute

Note: The temperature at the unit air intake can be significantly higher than room temperature. Temperature is affected by rack configuration, floor layout, air conditioning strategy, and other issues. To prevent performance failure and unit damage, make sure the temperature at the unit is continuously within the operating temperature range.

PHYSICAL

Construction	Steel cabinet	
Finish	Gray metallic with black end caps	
Bezel	Black matte finish	
Chassis		
Dimensions		
NET5308T	16.7" D x 17.0" W x 3.4" H	(42.4 x 43.2 x 8.6 cm)
NET5308T-EXP	16.7" D x 17.0" W x 1.7" H	(42.4 x 43.2 x 4.3 cm)
Mounting		
NET5308T	Desktop (feet) or Rack* (2 RU per set)	
NET5308T-EXP	Rack* (1 RU)	
	*Rack ears and screws provided	
Weight	Unit	Shipping
NET5308T	26.7 lb (12.1 kg)	40 lb (18.1 kg)
NET5308T-EXP	13.4 lb (6.1 kg)	20 lb (9.1 kg)

CERTIFICATIONS

- CE, Class A; meets EN50130-4 standard requirements
- FCC, Class A
- UL/cUL Listed
- C-Tick
- CCC

OPTIONAL MOUNTING ACCESSORIES

WM5300	Vertical wall mount kit for one NET5308T set and one NET5308T-EXP unit
--------	--



Pelco, Inc. Worldwide Headquarters:

3500 Pelco Way, Clovis, California 93612-5699 USA
USA & Canada Tel: (800) 289-9100 • FAX: (800) 289-9150
International Tel: +1 (559) 292-1981 • FAX: +1 (559) 348-1120
www.pelco.com

Pelco, the Pelco logo, Endura, the Endura logo, and Coaxitron are registered trademarks of Pelco, Inc. EnduraView is a trademark of Pelco, Inc. Product specifications and availability subject to change without notice. ©Copyright 2008, Pelco, Inc. All rights reserved.