

Multi-Port, 10/100 Mbps Switching Standalone Media Converter

AccessConverter



PRODUCT FEATURES

- Low cost, high flexibility — same small unit performs media conversion and switching functions
- Offers three downlink connections
- Compact size allows for flexible installation configurations
- Unmanaged

Terminating a fiber run while using various local, copper-based devices such as PCs, printers, VoIP, etc. is essential for the success of Fiber-to-the-Business, Curb and other FTTx projects. Remote locations have similar configuration demands. Connecting the multiple copper devices to the fiber, however, typically requires the use of both a media converter and a switch— two pieces of equipment to purchase and two pieces of equipment to monitor and maintain. The AccessConverter streamlines FTTx projects as well as the connection of remote locations as a multi-port, switching media converter.

Best of all, one compact AccessConverter module reduces the amount of required equipment while providing all the features of a switch (store and forward switching mechanics, MAC address learning, protection against broadcast storms, flow control, etc.) and performing the electrical-to-optical conversion. In addition, the unit's small size and wall-mount bracket (included) allow you to install AccessConverter virtually anywhere, including inside a network interface device (NID).

Requiring no configuration, the AccessConverter offers plug-and-play operation:

- Each copper port auto-senses the connected device's speed and duplex mode (10 Mbps or 100 Mbps and HDX or FDX) and includes AutoCross, a feature which automatically selects between a crossover workstation (MDIX) or pass-through (MDI) connection depending on the connected device
- The fiber port always operates at 100 Mbps FDX, and supports distances up to 80 km; single-strand fiber versions are available.

ORDERING INFORMATION

MODEL NUMBER	FIBER	FIBER PORTS	RANGE	ETHERNET PORTS	ETHERNET CONNECTOR
AccessConverter					
852-10140			100 m	4	RJ45
852-10150	MM850-ST	1	2 km	3	RJ45
852-10151	MM850-SC	1	2 km	3	RJ45
852-10141	MM1300-ST	1	5 km	3	RJ45
852-10142	MM1300-SC	1	5 km	3	RJ45
852-10141-MT	MM1300-MT	1	5 km	3	RJ45
852-10143	SM1310/PLUS-ST	1	40 km	3	RJ45
852-10144	SM1310/PLUS-SC	1	40 km	3	RJ45
852-10145	SM1310/LONG-ST	1	80 km	3	RJ45
852-10146	SM1310/LONG-SC	1	80 km	3	RJ45
852-10147	SM1550/LONG-SC	1	80 km	3	RJ45
SINGLE-STRAND FIBER *					
852-10153	SSFX-SM1310-SC	1	20 km	3	RJ45
852-10154	SSFX-SM1550-SC	1	20 km	3	RJ45
852-10155	SSFX-SM1310/PLUS-SC	1	40 km	3	RJ45
852-10156	SSFX-SM1550/PLUS-SC	1	40 km	3	RJ45
852-10157	SSFX-SM1310/LONG-SC	1	60 km	3	RJ45
852-10158	SSFX-SM1550/LONG-SC	1	60 km	3	RJ45

* These products have single-strand fiber technology. Deploy in pairs or connect another compatible B&B IMC LLC single-strand fiber product.

Multi-Port, 10/100 Mbps Switching Standalone Media Converter

AccessConverter



SPECIFICATIONS

TECHNICAL

- Auto Negotiation of speed and duplex (HDX/FDX) on copper ports
- Layer 2 packet switching, store and forward operation
- Forwarding rate: 14,881pps for 10 Mbps; 148,810pps for 100 Mbps
- 1024 MAC address learning
- MTU: Supports over-sized packets up to 1536 bytes
- Full wire speed on all ports
- Broadcast storm protection
- AutoCross for MDI/MDIX
- LinkLoss and FiberAlert
- Auto Negotiation
- Diagnostic LEDs
- 50/125µm or 62.5/125µm multi-mode fiber
- 9/125µm single-mode fiber
- Single-strand fiber
- All copper version also available (TX/3 + TX)
- IEEE 802.3 10Base-T
- IEEE 802.3u 100Base-TX
- IEEE 802.3u 100Base-FX
- IEEE 802.3x Flow Control

CONNECTORS

- RJ45, ST, SC and MT-RJ
- Supports Half- and Full-Duplex operation

MECHANICAL DIAGRAM

(dimensions in inches & millimeters)

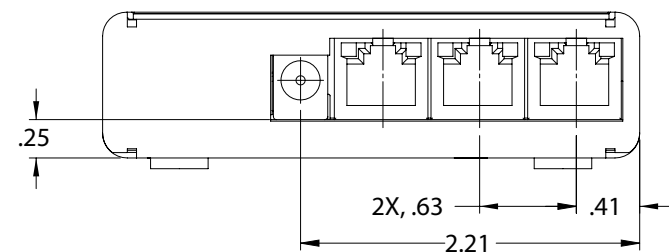
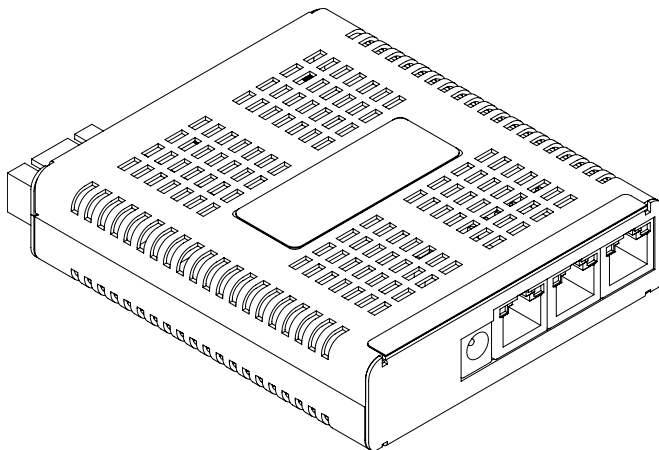

MECHANICAL

- Dimensions: 0.92"H x 3.50"W x 4.38"D (2.34 x 8.89 x 11.13 cm)
- Shipping Weight: 1.1 lbs. (0.50 kg)

POWER RATING

5V DC, 1A

ENVIRONMENTAL

- Operating Temperature: +32° to +122° F (0° to +50° C)
- Storage Temperature: -13° to +158°F (-25° to +70° C)
- Operating Humidity: 5% to 95% (non-condensing)

REGULATORY APPROVALS

- FCC Class B
- UL/cUL, CSA, CE

