

DESCRIPTION

The Model E-ML is an omni-directional, low impedance, electret condenser microphone with microphone level audio. Normal pick-up pattern is approximately 15' from the microphone location, all directions, or within 30' diameter circle. The unit comes with 20' pre-made cable with a stereo plug on one end that can be plug directly to the Audio Input of an IP camera. Designed for outdoor applications or where moisture may be present.

E-ML Microphone



SPECIFICATIONS

■ Sensitivity	-45 dB/pa
■ Frequency response	50 Hz to 8 kHz
■ Output Impedance	1k Ω
■ Current drain	0.8mA
■ Supply voltage	1.8Vdc to 4.5Vdc
■ Microphone housing	Single gang Bell Box
■ Dimensions (faceplate)	4 3/8"H x 2 3/4 "W x 2 1/5"D
■ Weight	15.5 oz
■ Shipping Weight	1 lb

INSTALLATION AND OPERATING INSTRUCTIONS

MOUNTING INFORMATION

The Model E-ML Microphone is designed for surface mounting to a wall or a pole. It should be located 6 to 8ft. from the area of desired coverage. One inch threaded knock-outs are located at the top and back side of Bell Box® for conduit connection. As a finished unit, the Model E-ML Microphone is classified as **WEATHER RESISTANT**. **Sealing around face plate and conduit connection is required**. Make certain Model E assembly is mounted so that microphone portion is facing downward.

MICROPHONE CONNECTION

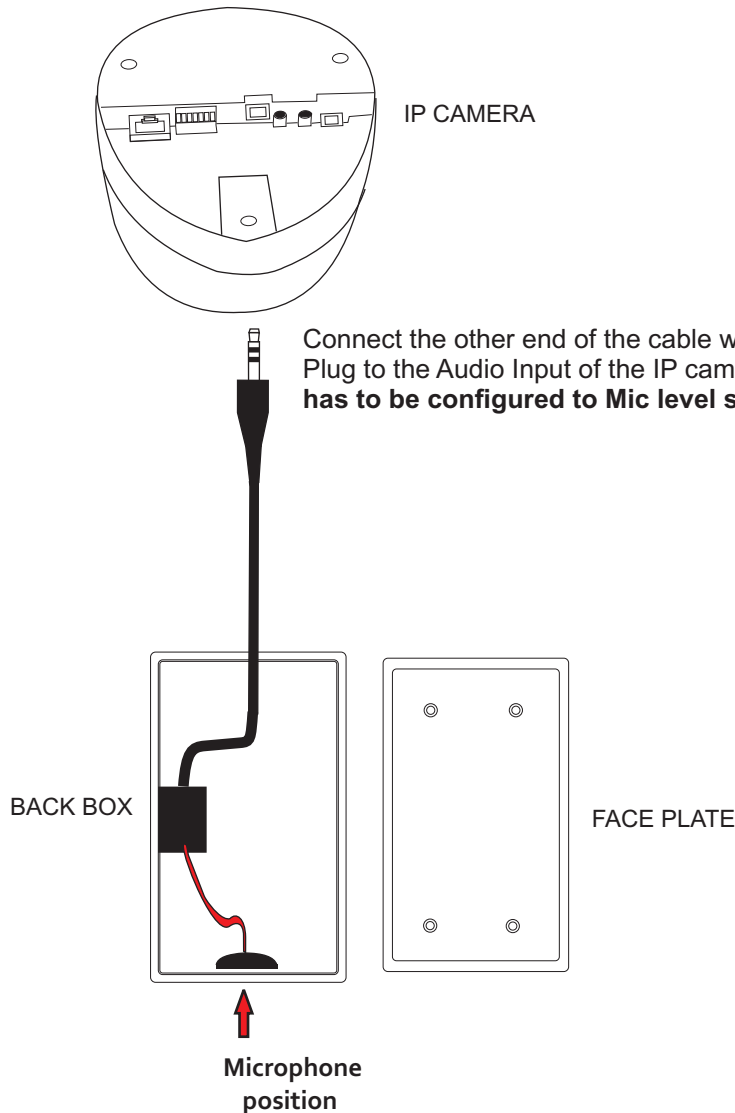

IMPORTANT NOTICE

When this equipment is used as part of an audio monitoring system, the law requires that the public be given notice of AUDIO MONITORING ON THE PREMISES. A decal notice is included with each microphone shipped.



Federal Law References:
Federal Regulations, US Code, Title 18.
Crime and Criminal Procedure, Sec 2510.

WARRANTY

LOUROE ELECTRONICS® warrants that at the time of shipment products manufactured by LOUROE ELECTRONICS® to be free of defects in material and workmanship. Should a defect appear within one year (12 months) from date of shipment, LOUROE ELECTRONICS will, at its sole discretion, repair or replace the defective equipment. This equipment shall not be accepted for repair or return without prior notification by LOUROE ELECTRONICS®.

This warranty does not extend to any Louroe product that has been subjected to improper or incorrect installation, misuse, accident, or in violation of installation instructions provided by LOUROE ELECTRONICS®.

Returned shipments to LOUROE ELECTRONICS® shall be at customer's expense. LOUROE ELECTRONICS® will return the equipment prepaid via best way.