



# OMNI-IP

## Scalable IP Solutions

 **KNC-p3TR4XIR**

3MP EXIR Network Camera  
Rugged Turret Style with IR  
Super Beam LED  
IP66, POE + DC12V



**INNOVATIVE**  
HIGH DEFINITION SURVEILLANCE

# OMNI-IP

## Scalable IP Solutions

**KNC-p3TR4XIR**

**3MP EXIR Network Camera**  
**Rugged Turret Style with IR**  
**Super Beam LED**  
**IP66, POE + DC12V**



### Features

- Omni IP 'hand free' Plug-and-Play system: just connect to PoE switch and stream video
- View and record 3MP resolution at up to 20FPS from 1/3" progressive scan CMOS sensor
  - 3MP images contain NINE times the pixel detail versus traditional analog images
  - At 3X digital zoom, a 3MP images display more detail than a basic analog camera
- Real time 30FPS streaming at 1920x1080 (1080p)/1280x720 (720p)
- Low light sensitivity of .07lux with
  - True Day/Night (ICR) for best daytime color reproduction and low/no light sensitivity
  - Low/no light coverage enhanced by EXIR Super Beam IR LED with 100 foot range
  - Smart IR Control of image contrast despite bright, close in objects in scene
- Extensive OSD capabilities, many controlled directly from Omni IP NVR
  - Dual streaming in H.264/MJPEG with fixed/variable bandwidth control from 32Kb/s to 12.3Mb/s
  - Region of Interest allocates bandwidth to maximize resolution in priority areas within scene
  - Day/night and IR switching control by photo sensor or schedule (or disable IRs if desired)
  - In-camera detection of motion, video loss or tampering with alarm reporting to NVR
  - 3D DNR improves low light image clarity and reduces bandwidth/NVR disk utilization
  - DWDR compensates bright or unbalanced scene lighting
  - BLC specifically for handling scenes with back lit subjects
- Lens focal length of 4mm covers 70° field of view; optional 2.8mm lens for wider view or 6 & 12mm for greater magnification\*
- Dual PoE/12VDC power
- PoE for efficiency and convenience
  - 12VDC for legacy system upgrade or beyond PoE cable distance range
  - Operate almost anywhere: IP66 weather resistance and -22°F~140°F temperature range
- Turret style housing is adjustable for 360° pan and rotation, with 75° tilt for flexible positioning
- Support for Safari/Chrome/FireFox/IE web browsers with free plug-in
- Customized installation with KA-TRWM1 Wall Arm; KA-BRPM1 Pole Mount & KA-BRCM1 Corner Mount for use with KA-TRWM1

Dimensions (Unit: mm)

Accessories

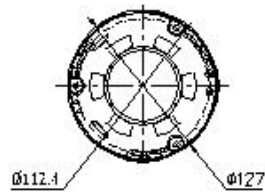
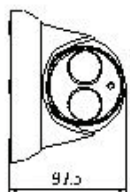

KA-BRCM1  
Corner Mount



KA-BRPM1  
Pole Mount



KA-TRWM1  
Wall Mount for  
Turret Camera



### Technical Specifications

Image Sensor	1/3" Progressive Scan CMOS
Total Pixels (H x V)	2048x1536 3 Megapixel @ Maximum Resolution
Day & Night	True Day & Night with ICR; Controllable by light sensor or via schedule
Min. Illumination	.07lux @ F1.2, AGC on 0 Lux (IR LED On; IR may be disabled in OSD)
IR LED	One Super Beam High Power IR LED 850nm
IR Distance	100 ft. (30m) Nominal IR performance depends on scene reflectivity
Smart IR	OSD Controlled Off/On
Shutter Speed	1/30s ~ 1/100,000s
DWDR/BLC	DWDR: Off/On, Level Adjust BLC: Off/Top, Bottom, Left, Right, Center Weighted
White Balance	AWB; Locked; Incandescent, Warm, Natural or Fluorescent Light
3D DNR	Off/On, Level Adjust
Focal Length (standard)	4mm F=2.0 2.8mm, 6mm, 12mm
Lens Options	
Lens Angle	2048 × 1536: Angle of view: 86°(2.8mm), 70°(4mm), 43.3°(6mm), 20.6°(12mm) 1920 × 1080: Angle of view: 98.5°(2.8mm), 79°(4mm), 49°(6mm), 23.2°(12mm)
Lens Type	Fixed focal length
Main Stream	2048x1536 1920x1080 1280x720
Supported Resolutions Sub Stream	320x240 352x240 640x480 704x480
Maximum Frame Rates	20FPS@2048x1536 ; 30FPS@1920x1080 ; 30FPS@1280x720
Compression	H.264 Main Profile & MJPEG
Bit Rate	Nominal rates from drop down: 1024, 2048, 3072, 4096, 6144, 8192 Kbps Customized rates: 32Kbps~12288Kbps
Streaming	Dual-Stream at different frame rates and bandwidth
Region of Interest	Image detail priority/enhancement for up to four user defined areas for main and/or sub stream
Image Settings	Brightness, Contrast, Saturation, Sharpness, Hue, AGC Gain, Image rotation/mirror, 50/60Hz system, Text overlay (Name, Time/Date, Fixed Labels; adjustable for position, size, color, etc.), Privacy masking
LAN	Ethernet 10/100 Base-T (RJ-45 Type) with weather sealed shell
Security	Multiple user access levels with password protection; Watermarking of captured video IP address filter; IEEE802.1X (Authentication)
Protocol	IPv4, IPv6, HTTP, TCP/IP, ICMP, DHCP, DNS, DDNS, RTP, RSTP, RTCP, uPnP, IGMP, PPPoE, SMTP, NTP, SNMP, HTTPS, FTP, 802.1X, QoS, Bonjour
Network Storage	Video upload to PC, FTP or NAS
VMS Compatibility	ONVIF, PSIA, CGI, ISAPI
Supported Browsers	Internet Explorer, Chrome, FireFox, Safari (with O/S compatible plug-in)
Video Motion Detection	With arming schedule and multiple actions: notify NVR, send email, upload to FTP, trigger alarm output
Alarm Triggers	Intelligent video Motion Detection, Video Loss, Tampering
Alarm Events	Notify NVR, send email, upload to FTP, trigger alarm output
Angle Adjustment	Pan: 0~360° Tilt: 0~75° Rotate: 0~360°
Power	PoE class 3 (IEEE 802.3af) 12VDC +/- 10% 5.5W nominal; 7.5W IR LED on
Interface	8P/8C RJ-45F for Network and PoE Power (DC 12V) Input
Environmental	IP66 (Weather Resistant)
Operating Temperature	-22 °F ~ 140 °F (-30 °C ~ 60 °C)
Dimension	5" diameter/3.84" high [127mm dia./97.5mm high]
Weight	1.5 lbs./670 grams
Mounting Options	KA-TRWM1 Wall Arm; KA-BRPM1 Pole Mount, KA-BRCM1 Corner Mount for use with KA-TRWM1

www.ktncusa.com

Ordering Info: KNC-P3TR4XIR: 4mm | KNC-P3TR3XIR: 2.8mm | KNC-P3TR6XIR: 6mm | KNC-P3TR12XIR: 12mm

\* See detailed specs for field of view at different combinations of focal length and resolution  
KT&C America, Inc. reserves the right to make changes to improve our products at any time without notice; we are not responsible for misprints.