



OMNI
Resolution 960
Everyday

 **KPC-VDNS102NUV**

Outdoor, Digital Day/Night 750 TVL,
Rugged, 3-Axis, 2.8-12mm, IP66,
Dual Voltage, -40°



INNOVATIVE
HIGH DEFINITION SURVEILLANCE



OMNI
Resolution 960
Everyday

KPC-VDNS102NUV

Outdoor, Digital Day/Night 750 TVL,
Rugged, 3-Axis, 2.8-12mm, IP66, Dual
Voltage, -40°

Features

- Superlative resolution of over 750 horizontal TV lines for amazing image quality
- 960H CCD sensor with high IR sensitivity in low light without DSS boost
- Full motion color or digital day/night during low ambient light without ghosting
- Simple and easy to use OSD setup menu
 - Digital Wide Dynamic Range for proper contrast in challenging bright or unbalanced scene lighting conditions
 - Anti Color Roll for proper white balance independent of fluorescent or other types of illumination
 - Programmable Back Light Compensation (BLC) and Highlight Compensation (HLC)
 - Adjustable 2D-Noise Reduction to increase low light picture clarity and conserve DVR HDD disk space
 - Privacy masking for 8 configurable zones
 - Lens shading compensation for even exposure out to the lens periphery
- 2.8~12mm 2 Megapixel Aspheric Varifocal DC iris lens to capture the desired field of view
- Dual voltage (12VDC/24VAC) with Anti Color Roll
- IP66 weather resistant
- Extreme Operating temperature down to -40 degrees
- Service Video output for convenient installation, and ease of service
- 3-Axis gimbal for convenient wall or ceiling mounting
- Flush or Surface mountable (surface mounting/splice box fits standard 3/4" conduit and electrical boxes)
- KA-WM100 Optional wall mount bracket with 3/4" conduit fitting

Dimensions: Inches (mm)

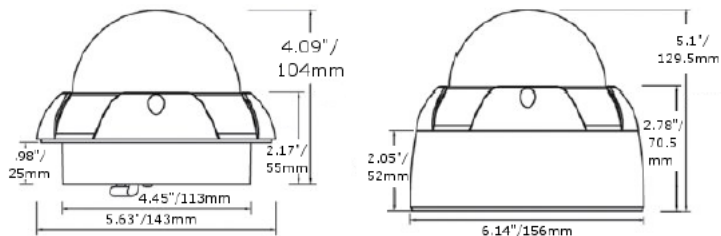

Accessories



KA-WM100
Wall Mounting Bracket
with 1/2" conduit fittings
top and bottom



Digital Day/Night **750 TVL** **Digital WDR** **2.8-12 mm** **3 Axis** **Rugged Housing** **IP66 Water Resistant** **-40°F** **DC12 Dual Voltage AC24V**
Surface or Flush Mount **OSD** **BLC HLC** **Low Light Performance** **Anti-CR** **Service Video**

Imaging Device	1/3" 960H High Sensitivity CCD
Video Format	NTSC
Picture Elements	NTSC: 1020(H)x508(V)
Effective Picture Elements	NTSC: 976(H) x 494(V)
Horizontal Resolution	More than 750 TVL
Sensitivity	.01 lux native from sensor – no ghosting With lens: .1 lux
S/N Ratio	Over 50dB (AGC off)
Video Output	BNC 1.0V p-p 75Ω; video test point inside dome, cable supplied
Gamma Correction	0.45
Lens Type	2 Megapixel Aspheric Varifocal DC Iris 2.8~12mm F=1.6
Lens Positioning	3-axis flexible positioning for wall or ceiling mounting
Back Light Compensation	OFF/BLC/HLC Selectable
Auto Gain Control	Off/Low/Middle/High
Electronic Shutter	Auto; or 1/60, FLK, 1/250, 1/500, 1/1000, 1/2000, 1/4000, 1/5000, 1/10000, 1/100000
White Balance	ATW/AWB/AWC->SET/Anti-Color Roll/Manual
Sync. Mode	Internal (plus Anti-Color Roll White Balance option above)
Day & Night	Digital D/N control; Choose Auto, Color or B/W
OSD Menu	Multiple functions using 3-axis joystick
OSD Languages	English, Spanish, Portuguese, German, Russian, Japanese, Chinese, French
2D-DNR	On/Off (Level Adjustable)
Digital Wide Dynamic Range	On/Off (Level Adjustable)
Mirror	Off/On
Motion Detection	Off/On for 4 selectable zones (On screen indication)
Privacy Mask	Off/On for 8 selectable zones
Lens Shading Correction	Off/On with adjustable level and center
Other OSD Functions	Camera Title with position, Font Color, Image Contrast/Sharpness, CRT/LCD display optimization, Negative Image, DPC (Dead Pixel Compensation)
Power Source	12VDC/24VAC
Power Consumption	12VDC:1.60mA max. / 24VAC:1.8W max.
Operating Temperature	-40°F~140°F ; -40°C~60°C
Environmental	IP66 weather resistant
Mechanical	Vandal proof dome; back box accepts 3/4" conduit fittings and hole pattern matches various standard electrical boxes; remove back box for flush mounting
Dimensions	Surface: 6.14"/156mm dia. x 5.1"/129.5mm high Flush: 5.63"/143mm dia. X 3.11"/79mm visible & .98"/25mm behind surface
Weight	1.2 pounds flush mounted; 2.8 pounds with surface mount conduit compatible back box
Certifications	CE / FCC RoHS
Environmental	IP66 weather resistant

www.ktncusa.com

KPC-VDNS102NUV17: 2.8-12mm